

COWBRIDGE

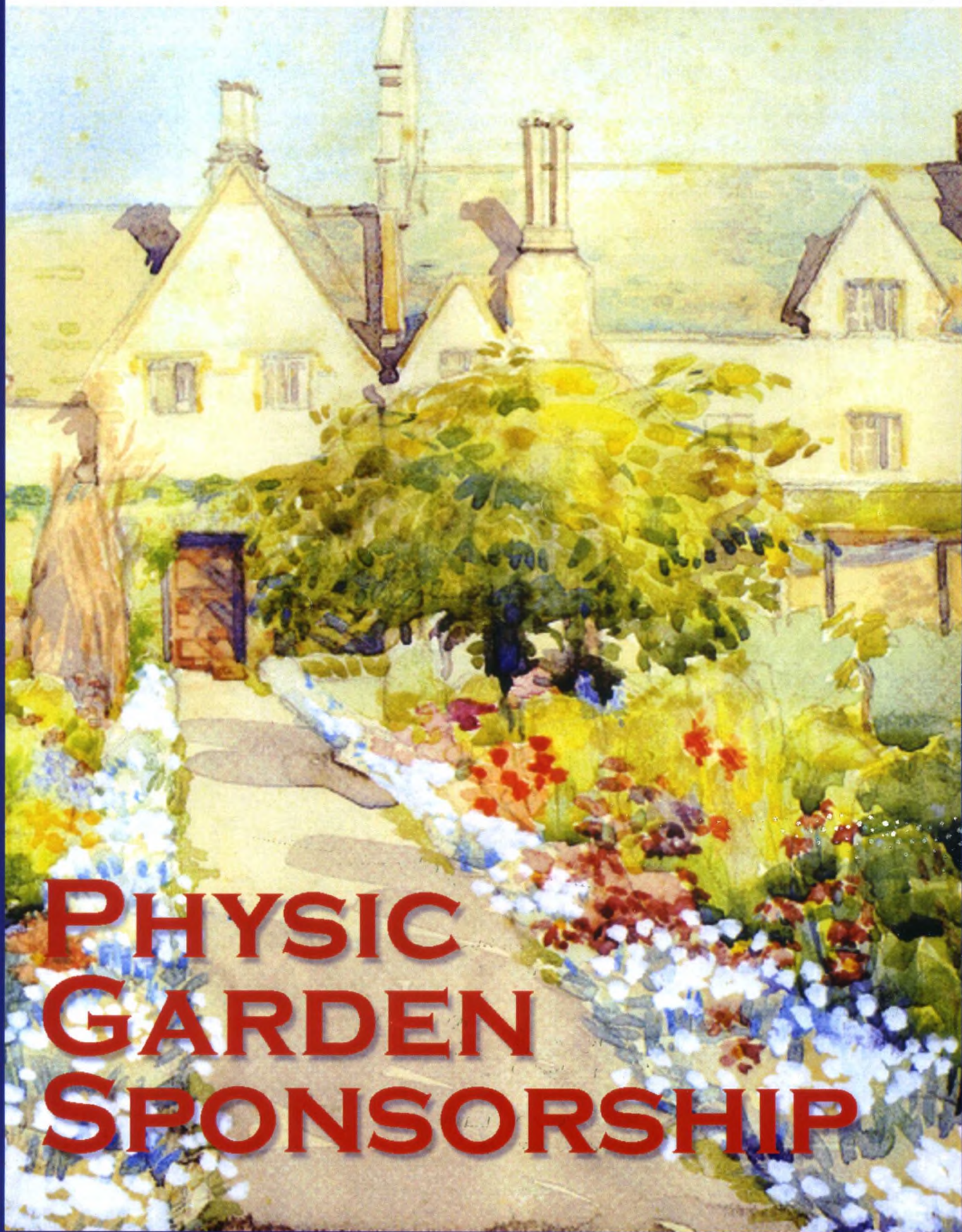

**PHYSIC
GARDEN
SPONSORSHIP**

INTRODUCTION

Phase I of the development of the Cowbridge Physic Garden, which included clearing the site, reinstating the west wall and laying out the hard landscaping of the garden was completed at the end of 2005.

Phase II, the restoration of the potting sheds, repair of the existing walls, the surfacing of the paths and the planting of the garden is currently underway and will be completed by September 2006.

The creation of the Cowbridge Physic Garden remains on programme and on budget!

The Committee now seeks to raise the funds required to 'enhance' the garden by the inclusion of major architectural features including the central fountain, two pavilion summerhouses, a stone column and oak pergola and a wire trellis and ogee arch screen. Sponsorship is also sought for individual trees, the rose collection, the espaliered fruit trees and benches for the garden.

Listed on the following pages are details of each element where sponsorship is needed, and the costs involved.

For more information, or if you wish to discuss any aspect of sponsorship, please contact me or our Treasurer, Mrs. Genevieve Foster-Thomas on the numbers listed below.

The Trustees thank you for your interest and support.

Dan Clayton-Jones, Chairman

Dan Clayton-Jones

Tel: 01443 227373
Mobile: 07970 433645
email: dan.clayton-jones@talk21.com

Genevieve Foster-Thomas

Tel: 01446 774534
email: genevieve.thomas@ukgateway.net

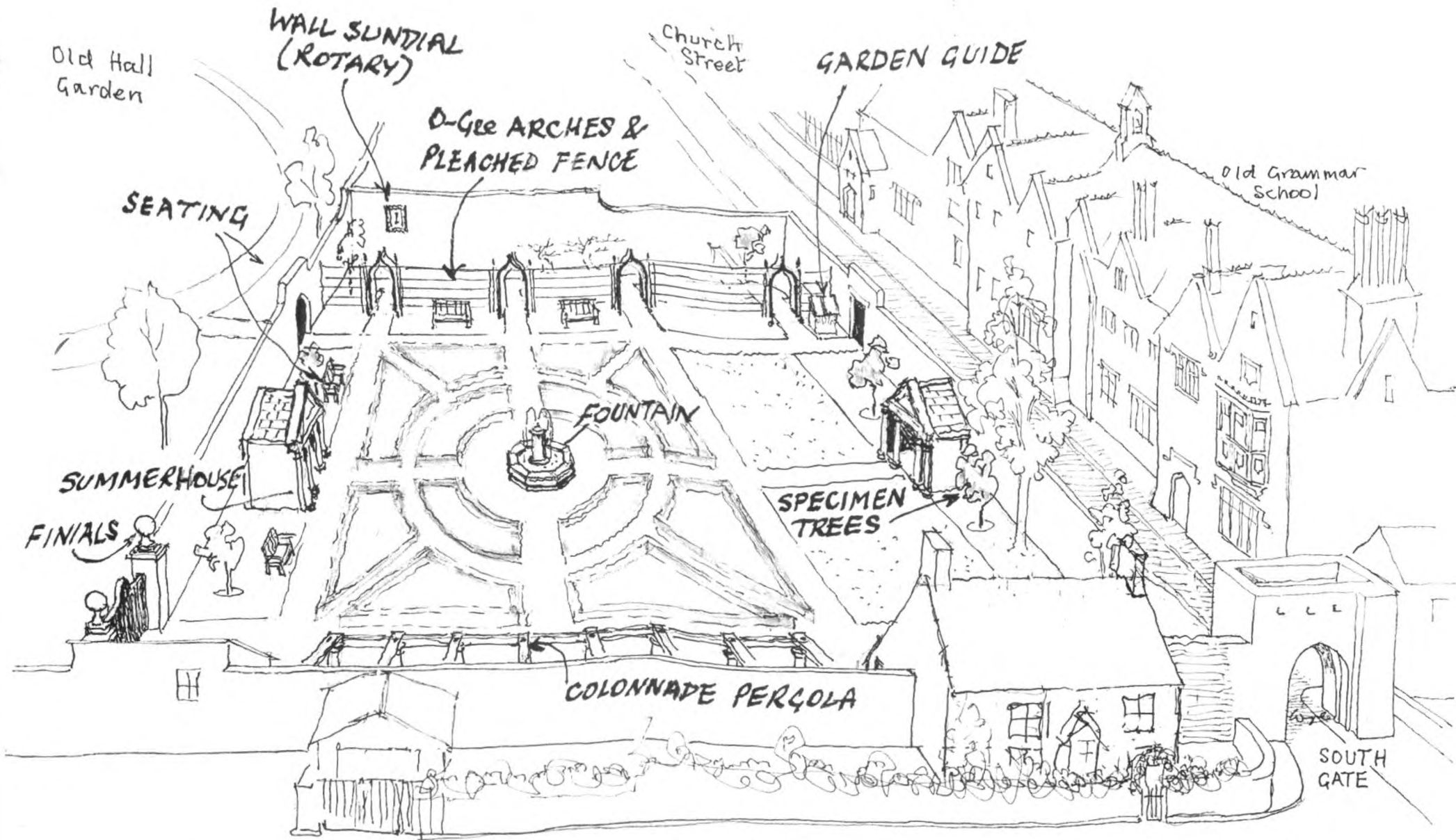

SKETCH OF PHYSIC GARDEN-FEATURES

April 06

TREES

All trees and plants in the Physic Garden are restricted to those that were available before 1800, reflecting the Georgian concept of the garden.

EVERY TREE WILL BE GUARANTEED AND WILL BE REPLACED FREE IN THE EVENT OF FAILURE.

Common Name and Botanic Name	Description	Height at planting	Mature Height	Cost
Black Mulberry <i>Morus Nigra</i>	Introduced by Romans and widely planted by James I. Medium tree. Very attractive	3m	10 - 15m	£85
White Mulberry <i>Morus Alba</i>	Beautiful small architectural tree. Rounded habit. White of pink fruits - edible. Leaves main food of silkworms.	2m	5 - 10m	£90
Magnolia Evergreen <i>Magnolia Grandiflora</i>	Medium stature. Conical habit. Green leaves tinted reddish brown underneath. Large white flowers.	4m	10 - 15m	£300
Maidenhair Tree <i>Ginkgo Biloba</i>	Prehistoric survivor. Large conical tree. Tolerant of air pollution. Curious fan-shaped leaves.	4m	20m +	£150
Rowan/Mountain Ash <i>Sorbus Aucuparia</i>	Wonderful native tree with abundance of red berries. Often multi-stemmed.	2.5m	10 - 15m	£100
Rowan/Mountain Ash <i>Sorbus Aucuparia Edulis</i>	The edible berries of this Rowan are used to make rowan jelly. A broadly oval tree in maturity.	2.5m	10 - 15m	£125
Japanese Pagoda Tree <i>Sophora Japonica</i>	Really a native of China! Medium to large lovely rounded tree. Yellow / white pea-like flowers in August.	3.5m	15 - 20m	£130
Sassafras <i>Sassafras Albidum</i>	Hardy tree with insignificant flowers but highly ornamental and varied leaves. Highly aromatic. Used to make 'tea'. From USA.	3.5m	10 - 15m	£130
Service Tree <i>Sorbus Torminalis</i>	The fruits are very sharp but edible when overripe. Known as 'Chequers' in Southern England. Native tree. Rounded when mature.	3m	10 - 15m	£100
Crab Apple <i>Malus Sylvestris</i>	Ornamental flowers in spring and fruits in autumn. Delightful tree.	3m	10m	£125
Common Holly <i>Ilex Aquifolium</i>	One of the most evocative and best loved of our native trees. Particularly attractive in autumn and winter.	3m	10m	£150

Fig Tree <i>Ficus Carica Moraceae</i>	Variety 'White Marseilles' rather than the 'Brown Turkey' fig will be grown. Does best fan trained against a wall.	1.5m	5m	£120
Quince <i>Cydonia Oblonga Rosaceae</i>	Grown for its pear-shaped fruits which are golden yellow when ripe. Strongly aromatic. Small tree but long lasting.	2m	5m	£120
Medlar <i>Mespilus Germanica</i>	In cultivation since early times. Small brown fruits only edible when bletted (half rotten). Large hairy leaves. White flowers in May.	3m	10m	£120
Hazel/Filbert <i>Corylus Avellana</i>	Native small tree with rounded habit. Produces long yellow 'lamb's tails' in early spring. The 'filbert nuts' are produced in autumn.	2.5m	10m	£75
Walnut <i>Juglans Regia</i>	Slow growing with medium to large stature. Has aromatic foliage from which wine can be made. Followed by crop of nuts.	4m	10 - 15m	£200
Common Almond <i>Prunus Dulcis</i>	One of the finest spring flowering trees. Beautiful pink single and double flowers.	3m	10m	£100

THE ROSE COLLECTION

This is a collection of some **25** individual plants including *Rosa Gallica*, *Rosa Centifolia*, *Rosa Damascena*, *Rosa Alba*, *Rosa Canina* and *Rosa Moss*. All varieties grown before 1800.

£250

THE FRUIT TREE COLLECTION

These historic varieties of fruit trees dating from the 16th to the 18th century will be trained in espalier and cordon fashion along with the wire trellis screen and on walls. Unusual apple trees include 'Tom Putt', 'Downtown Pippin', 'Catshead', 'Harvey' and 'Old English Permain'.

Pears include 'Black Worcester', 'Forelle', 'Catillac' and 'Jarçonelle' - **25** trees

£500



Sponsors of individual trees, 'The Rose Collection', and the 'Fruit Tree Collection' will be recorded in a commemorative leather bound book, displayed on site. Each gift will be recorded by a complete page produced by a qualified calligrapher giving details of the donor and dedication, plus the location of the tree/collection within the garden.

PLANTING BEDS

In line with the practise at the Chelsea Physic Garden medicinal plants will be grouped in beds reflecting parts of the human anatomy for which they were prescribed. Head, eyes, lungs, stomach etc. Each bed may be sponsored i.e. the 'Eye' bed by an opticians? and the donor's name will be recorded by a slate plaque and inscription in the bed.

£250 per small bed
£350 per larger bed

BENCHES

Initially 6 benches, measuring 2 metres long will be required in the central area of the garden. These will be of a matching 'Georgian' design in hardwood with a 'life' of 20 years (with maintenance). Each bench will be marked by a small (10cm x 6cm) inscribed brass plaque.

Cost per Bench £500

PIER CAPPINGS & FINIALS

A pair of pier cappings and ball finials for the two gate piers are required. These will match the original design of pier cappings and finials used at Old Hall by the Edmondes Family. Reconstituted stone. Inscribed brass plaque mounted on gate.

£750 for the pair

TRELLIS SCREEN & 'OGEE' ARCHES

The wire trellis will form a 'screen' across the garden, punctuated by four 'ogee' shaped metal arches over each cross path. The screen will form the support for the trained fruit trees and will be coloured 'French' blue. Donor plaque in slate. (Details on request.)

£3,000

POOL & FOUNTAIN

This will be the central feature of the garden. Consisting of an octagonal pool surround cast in reconstituted stone with bolection moulding and central lead fountain. Total cost includes pump, liner, water supply, excavations etc. Donor plaque in slate. (Details on request.)

£8,000

SUMMERHOUSES X2

Constructed from breeze block, walls lime rendered with a slate roof. The cast stone façade by Cranborne Stone with four Doric columns and stone pediment. York Paving to floor. Each 'Temple' pavilion will face each other across the main east-west axis of the garden. Oval slate donor plaque in each building. (Details on request.)

£12,000 for each pavilion

PERGOLA

Consisting of twelve stone Ionic columns surmounted by a green oak superstructure and sited at the southern end of the garden. Height 2.5m. Floored in reclaimed flagstone - slate dedication plaque in flooring.

£15,000

Total cost columns, oak superstructure, flooring, groundwork, steelwork and erection
(Details on request)

ORNAMENT PLINTH & URN

To be sited within the pergola. Design of urn to be decided. Plinth will have 'official opening plaque' attached. Donor plaque on reverse of plinth.

£1,000

(Details on request)



***All costs are inclusive of VAT which CANNOT be reclaimed
by Cowbridge Physic Garden Trust - a charitable company.**

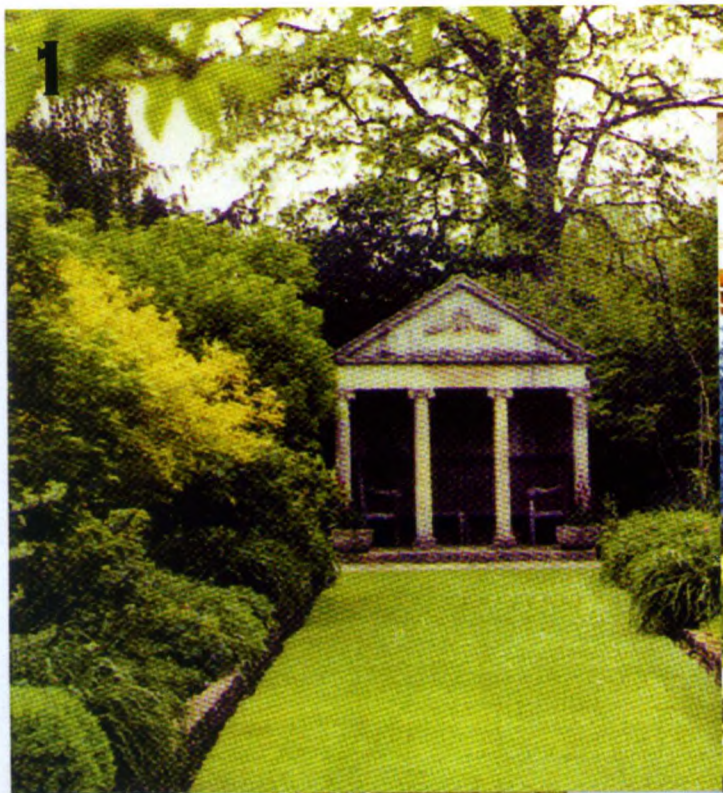

1

1. SUMMERHOUSE
2. PERGOLA

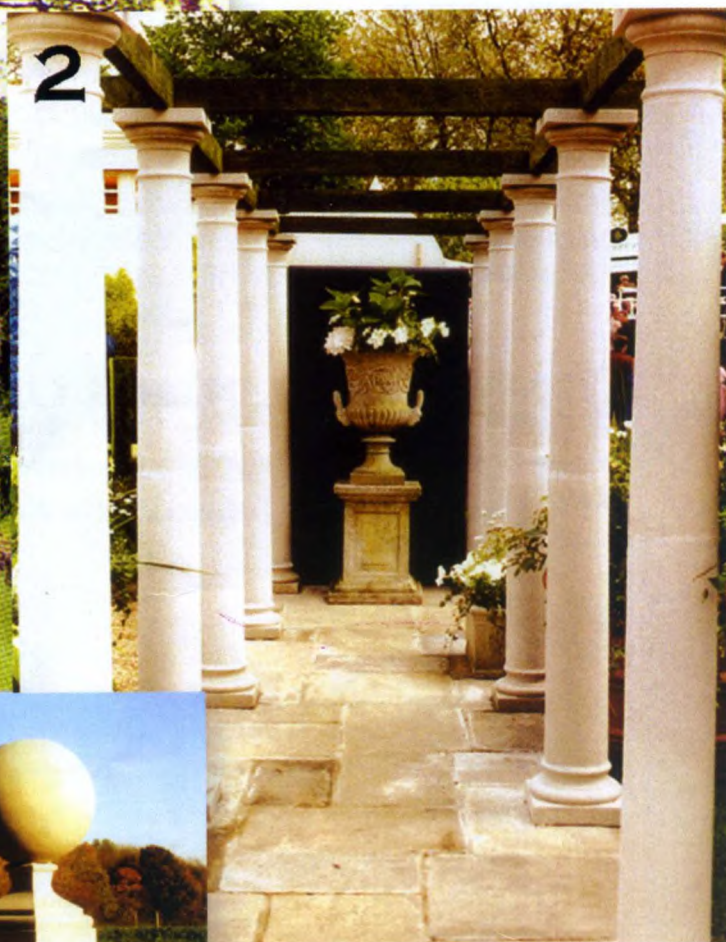

2



3



4

3. TREES
4. BALL & FINIALS



5



6

5. POOL & FOUNTAIN
6. ARCHES & TRELLIS