

From deeds of Westmoor Farm, Cowbridge

- 4/8/1781 Mr Thomas Thomas of C, gent and Mr Benjamin Thomas, ironmonger to Mr Wm Wathen of Llantwit Major, gent, and John Jones of Eglwys Brewis, gent lease for 1 year
- all that mess &c and several parcels of land, 16ac, in Coychurch
 - 13 acres of land near Stalling Down now in possn of Thomas Evan and sd Benjamin Thomas
 - barn in E village of C, now in possn Benj Thomas
 - cottage and gdn on E side of bridge in C now in possn Rees Thomas, printer
- 5/8/1781 Mortgage betw 1) Benj Thomas, ironmonger
2) Thos Thomas of C gent (trustee for BT)
3) Wm Wathen of LM + John Jones of EB
4) John Thomas of C, gent
- Whereas BT by deeds of lease and release of 17,8/6/1776 for securing the repayment of £600 and interest to Revd Gervas Powell of Llanharan has granted
- all that farm and lands called Llanquian farm containing abt 32 acres in Llb and Wsd late in possn of John Morris
- Benj Thomas was in debt to Wm Wathen and John Jones for £500 and £400, and conveyed the above property (of 4/8/1781) to WW and JJ
- also copyhold or customaryhold close now divided into two called the Smallway (4ac) near the road from C to Llanquian and now poss Isaac Skynner
 - also copyhold close calle dCaer lake (4 ¼ ac)
- 11/7/1799 Rt Hon Geo Talbot, Baron Dynevor, to John Bevan, surgeon sale of 2 closes of land in Llb under Acts for the Sale of the Land Tax
- close nr Heol y Smallway (3ac 1r) formerly occ Elizabeth Morgan, now in possn and occ of Wm Lewis at rent of £3.9s pa
 - close nr Heol y Smallway, 3ac formerly poss Wm Rees with other closes now poss Wm Lewis for £1.10s pa
- 11/1/1780 Court Baron, Manor of Llanblethian
Thos Llewellyn of C, maltster, attorney for Hannah Thomas, executrix of will of Benj Thomas, decd, and Revd Thos Thomas of Bristol (eldest son and heir at law of BT), and Wm Thomas of Manchester (youngest son and customary heir of BT) surrendered to the Lord and Lady of the manor
- 2 fields of c/h land abt 4ac adj Heol y Smallway, and the nursery and lands of Robt Taynton on S, W and N parts now in ten and occ Thos Thomas, to the use of John Bevan, surgeon
- 11/1/1800 Surrender by John Bevan to John Miles as feoffee for will of JB
- 22/11/1799 Lease for a year, Mrs Hannah Thomas and others to Revd John Nicholl of Cardiff
- a) barn and large gdn in E Village now and for many yrs in ten of Thos Jenkin, having
 - mess of Robt Jones Esq formerly Evan Seys, clerk, on E
 - ruined bldg of David Wms gent and formerly of Jenkin Wms on W
 - town walls on N
 - highway through C on S.
 - b) 2 closes nr Heol y Smallway (one of 5ac 8perches, the other of 3ac 1r 11

perches) with
 - Heol y Smallway on S
 - certain lands of Earl Talbot, Thos Edmondess and a common called Stalling Down also 2 other closes near Heol y Smallway of 5ac 9pch and 2ac 3r 14pch, with H y S on N, &c
 all which sd 4 closes now in ten and occ of Thos Thos

23/11/1799 conveyance of a) and b) above
 Hannah Thomas and others to John Bevan of C, surgeon

11/4/1806 court Baron, Manor of Llanblethian
 Surrender from Geo Talbot Esq (by virtue of surrender of settlement dated 24/12/1762) to John Bevan, gent, for £810
 - 3 pcels of customaryhold land adj each other, inc 8 ac known as Caia Summwr, one pcel adj road from C to Aberthin, all now occ Joh Bevan
 - 2 pcels of c/h land adj each other, 5a, adj Heol y Smallway and now occ John Kays currier
 - 2 pcels c/h land. 4 ac, adj rd from C to Stalling Down now occ John Bevan

11/4/1806 Geo Talbot, Esq to John Bevan, gent, Deed of Covenants

27/3/1821 Lease for 11 yrs, John Bevan to Jas Wheeler, innkeeper of C
 1) barn and gdn in E village having
 - dw ho of Evan Edwards shoemaker on E
 - cottage of Wm Lewis the younger on W
 - Millfield on N
 - highway on S
 2) 11 closes abt 37ac in Llb on N and S sides of Heol y Smallway which branches off the high road towards a farm called Llanquian
 all lately held by John Bevan now occ Jas Wheeler (the barn to be rethatched in wheat straw, and controls on land use).

20/11/1906 Mortgage of Stalling Down Farm and Aberthin lands, EM Dawson-Thomas Esq of Tregroes, Pencoed to JT Griffith Esq of Llansannor House
 Whereas Susanna Jane Moorman, Exmouth, wife of Admiral Richard Moorman, was at her death was seised of ppty, devised in 1897 to her nephew Edward Morgan Dawson-Thomas farmlands called Stalling Down and Aberthin, then occ Daniel Evans and David Thomas as tenants. Susanna Moorman died 1900; will proved 20/11/1900

lands occ John Rosser (plan attached)

Nos on OS map		Nos on OS map		Aberthin or Elms Land	
				Nos on OS Map	
360	pasture 2.903 ac	375	yard + bldg 0.100	465	pasture 3.861
361	yard shed and pool 0.098	374	arable 2.818	464	p 3.825
362	p 2.591	373	a 5.705	525	p (Elms Land)
363	p 2.861	372	a 4.376		4.492
364	p 3.005	368	p 3.470		
371	p 5.362	367	a <u>3.640</u>		
334	p 3.398				43.672

- 22/10/1923 memorandum on reverse of above:
Three indentures, conveying pptides:
a) to Robt Thomas of Oakley Ho, C and Lizzie his wife
Nos 360, 361, 362, 3,4,5,7 and 365 (sic) (368)
b) to William James Richards of Penylan Aberthin
371,334,375,373, 372 and 374
c) to Thomas Thomas of Llwynhelyg farm, 465,464 and 525
- 19/9/1923 Power of attorney: Edward M Dawson Thomas then of Fairfield RMDI, Duncan Vancouver Island, British Columbia, to sell mixed f/h and c/h farm, lands, etc called Stallingdown and Elms land, totalling 63ac, 2r, 10p in occ Wm James Richards as yearly tenant
[also f/h farm with farmhouse barn, stables, etc called Tile House farm at Boverton, 108a 16p in occ Llewellyn Thomas as yearly tenant]
- 22/10/1923 conveyance, as a) above, EMDT to Robert Thomas, bank manager
nos 360-365, 367, 368 = 21 ac 3r 26p
- 31/3/1931 conveyance, Robt Thomas and Lizzie his wife to Arthur George Ching of Whitchurch (stating that under the Property Acts 1022 and 1924 copyhold tenure had been extinguished, compensation paid to the Lord of the manor of Llanblethian) - fields as above
- 28/12/1933 (memo) AG Ching to Elizabeth Ellen Wayne Morgan, wife of Matthew Wayne Morgan, solicitor of Cowbridge, field 365.

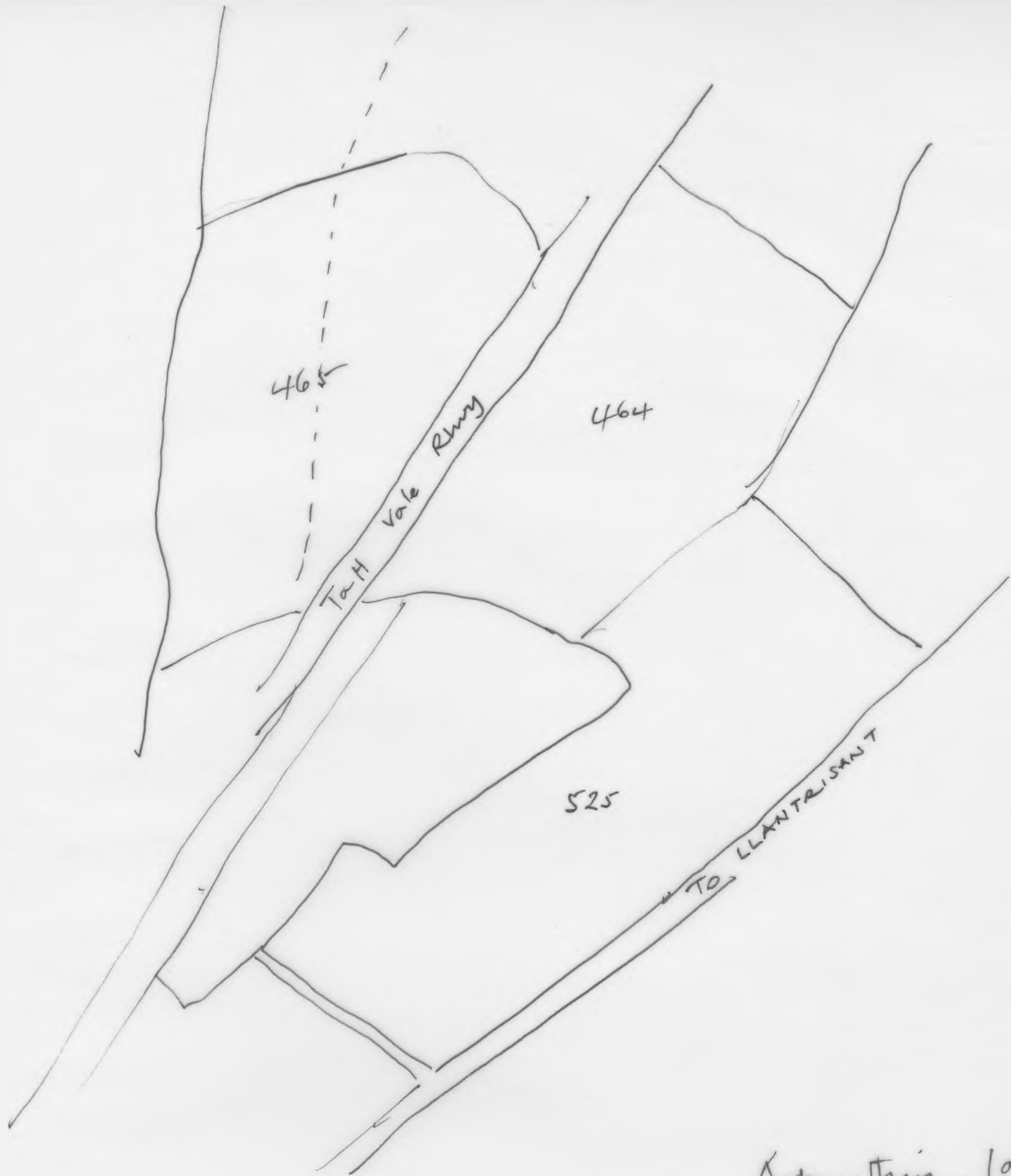

Aburthin Lands

20/11/1906

Stalling
Down Farm
20/11/1906

